

**GENERAL FLOOR PLAN NOTES:**

- CONTRACTOR TO PROVIDE ALL NECESSARY PERMITS & FEES REQUIRED TO COMPLETE THE PROJECT.
- CONSTRUCTION & INSTALLATION SHALL CONFORM TO ALL APPLICABLE LOCAL, STATE & NATIONAL BUILDING CODES & THE AMERICANS WITH DISABILITY ACT.
- ALL NEW WALLS SHALL BE CONSTRUCTED AS PER THE WALL TYPE & SHALL BE CARRIED TO THE STRUCTURE ABOVE, UNLESS OTHERWISE NOTED. PREPARE ALL SURFACES FOR FINISHES INDICATED.
- CONTRACTOR TO PROVIDE BLOCKING FOR ALL WALL SUPPORTED CASEWORK, TOILET ACCESSORIES, HANDRAILS, EQUIPMENT, DOOR STOPS, SHELVING, ETC. AS REQUIRED.
- ANY PENETRATIONS IN DESIGNATED FIRE WALLS SHALL MAINTAIN THE REQUIRED FIRE SEPARATION BETWEEN AREAS. CONTRACTOR TO PROVIDE SLEEVES, FIRE RETARDANT INSULATION & FIRE CAULKING AS REQUIRED.
- CONTRACTOR SHALL COORDINATE ALL WORK WITH EQUIPMENT MANUFACTURERS TO ENSURE APPROPRIATE ROUGH IN CLEARANCE FOR EQUIPMENT INSTALLATION & USE.
- WHERE MOUNTING HEIGHTS ARE NOT INDICATED, MOUNT INDIVIDUAL UNITS OF WORK AT A.D.A. STANDARD MOUNTING HEIGHTS FOR THE PARTICULAR APPLICATION INDICATED. REFER QUESTIONABLE MOUNTING HEIGHT CHOICES TO THE ARCHITECT FOR A FINAL DECISION.
- DO NOT SCALE THE DRAWINGS.
- ALL DIMENSIONS AND INTERIOR WALL THICKNESSES ARE FROM THE FINISHED FACE OF WALL TO FINISHED FACE OF WALL, UNLESS NOTED OTHERWISE.
- CONTRACTOR SHALL LAYOUT & MARK ALL WALLS & OPENINGS PRIOR TO CONSTRUCTION. ANY DISCREPANCY SHALL BE REPORTED TO THE ARCHITECT IMMEDIATELY FOR RESOLUTION.
- ENTIRE BUILDING TO BE EQUIPPED WITH AN APPROVED, SUPERVISED, AUTOMATIC FIRE SPRINKLER SYSTEM. THIS SYSTEM SHALL BE DESIGNED AND INSTALLED IN ACCORDANCE WITH NFPA 13 BY THE FIRE SPRINKLER CONTRACTOR.
- ALL FURNITURE AND EQUIPMENT NOT SPECIFICALLY NOTED ON PLANS SHALL BE SUPPLIED AND INSTALLED BY OWNER. CONTRACTOR SHALL COORDINATE ALL ELECTRICAL & DATA OUTLETS, ETC. IN FINAL FURNITURE LAYOUT DRAWINGS.
- ALL DOOR OFFSETS (HINGE SIDE) TO BE A MINIMUM OF 4", UNLESS NOTED OTHERWISE.
- REFER TO SITE PLAN SHEET FOR CONCRETE WALK LAYOUT.
- BULL-NOSE C.M.U. REQUIRED AT CORNERS- REFER TO INTERIOR WALL TYPES FOR ADD'L. INFORMATION.
- ALL GYP. BOARD SHALL RETURN TO ALL WINDOW/DOOR FRAMES AT JAMBS & HEAD, TYPICAL, UNLESS NOTED OTHERWISE.

**STANDARD FLOOR PLAN NOTATION:**

- INDICATES EXIT LIGHTS (SEE LIFE-SAFETY PLAN SHEET, REFL. CLG. PLANS AND ELECTRICAL PLANS FOR LOCATIONS)
- INDICATES SEMI-RECESSED FIRE EXTINGUISHER CABINET
- INDICATES FIRE EXTINGUISHER - MIN. 10" "A-B-C" (UNLESS NOTED OTHERWISE) OR OTHER AS REG'D. BY STATE AND/OR LOCAL CODE. SEE SPECIFICATIONS. (MOUNT AT 4'-0" A.F.F. MAX. TO TOP/EXTINGUISHER).
- FLOOR DRAIN
- CATCH BASIN
- INDICATES WALL TYPES, REFER TO INT. WALL TYPES FOR INFORMATION.

**VAPOR BARRIER NOTE**

- 15 MIL. POLY VAPOR BARRIER PER VOLUNTARY RESPONSE ACTION PLAN (VRAP) VAPOR BARRIER TO BE PLACED BENEATH THE ENTIRE BUILDING SLAB AND IS TO BE MECHANICALLY ADHERED TO THE FOUNDATION WALLS AND SEALED AROUND ANY UTILITY PENETRATIONS IN THE FLOOR SLAB.

**PLUMBING NOTES**

- IF PEX SUPPLY PIPING IS USED IN WALLS, TRANSITION FROM INSIDE WALL TO FIXTURES SHALL BE COPPER.
- PROVIDE WHITE PVC INSULATION COVER FROM 6" A.F.F. DOWN TO FIXTURE. EXPOSED PIPE INSULATION TO BE WHITE.
- EXPOSED VERTICAL (WALL) PLUMBING LOCATIONS TO BE COORDINATED BY OWNER AND/OR OWNERS EQUIPMENT SUPPLIER.
- A SEDIMENT REMOVAL SYSTEM IS REQUIRED AT THE CAR WASH AREA PER THE CITY OF BUFFALO.

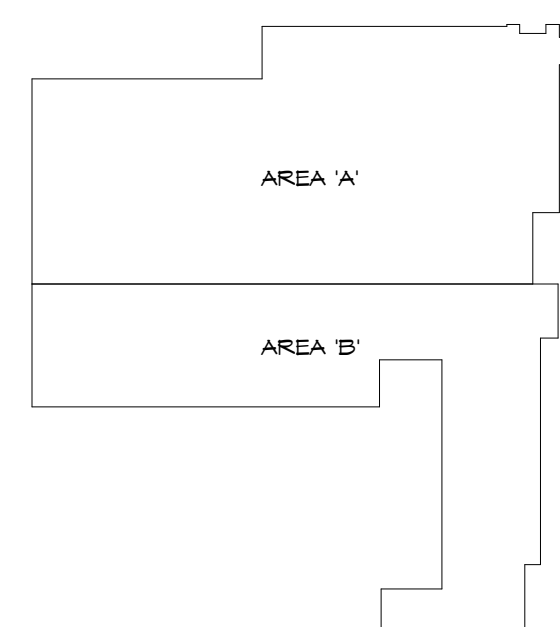

**KEY PLAN - OVERALL**  
1" = 80'-0"

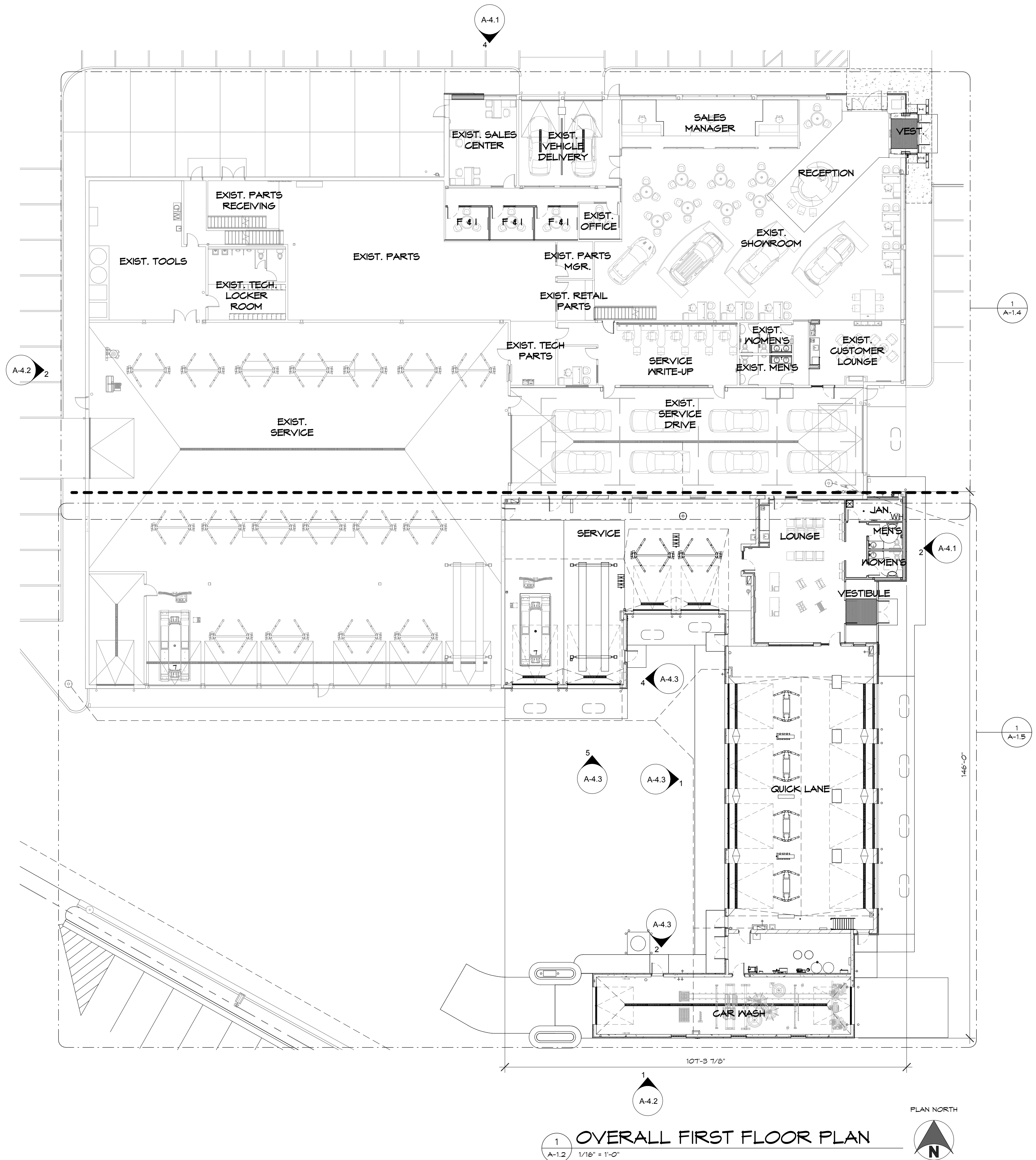

**OVERALL FIRST FLOOR PLAN**  
1" = 1/16" = 1'-0"

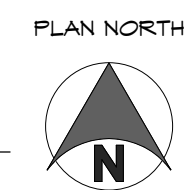

**BUILDING ALTERATIONS & ADDITION FOR:**  
**MORRIES BUFFALO FORD**  
**BUFFALO, MINNESOTA**

date: 01/13/2017  
job: 16-041  
d. by: KJF  
rev.:

**A-1.2**